

Type MA 132

2-way solenoid valve
direct actuated, NO
(normally open)

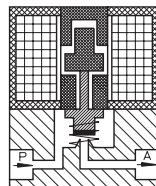

Application
Neutral liquids, gases
and vapors

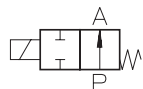

Type/ Order No.	Orifice [mm]	Port size	Pressure range [bar]		kv-value [m³/h]	Weight [kg]
			AC	DC		
MA 132-011	2,0	G1/4	0 - 10	0 - 10	0,06	0,200
MA 132-012	2,0	G1/4	0 - 10	0 - 10	0,06	0,250
MA 132-013	2,5	G1/4	0 - 7	0 - 7	0,10	0,200
MA 132-014	2,5	G1/4	0 - 7	0 - 7	0,10	0,250
MA 132-015	3,0	G1/4	0 - 5	0 - 5	0,17	0,200
MA 132-016	3,0	G1/4	0 - 5	0 - 5	0,17	0,250
MA 132-017	3,5	G1/4	0 - 3	0 - 3	0,24	0,200
MA 132-018	3,5	G1/4	0 - 3	0 - 3	0,24	0,250

Sealing material: **P** (NBR) **E** (EPDM) **V** (FPM)

Body material: Brass
 Inner parts: Stainless steel (1.4105)
 Mounting direction: Free, preferred upwards
 Max. ambient temp.: 50 °C
 Viscosity of the medium: max. 21 mm²/s (3 °E)
 Static pressure: max. 30 bar
 Standard voltage: DC: 24, 12 V
 AC: 230 V, 115 V, 42 V,
 24 V, 12 V, (50 or 60 Hz)

Power consumption: 11 VA / 8 W
 Voltage tolerance: -15%... +10%
 Duty cycle: 100 %
 Operating frequency: max. 360/min
 Degree of Protection: IP 54 (EN 60529)
 Plunger guide tube: Brass
 Internal circuit for AC: Y

94

Other configurations upon request

The right to modification is reserved

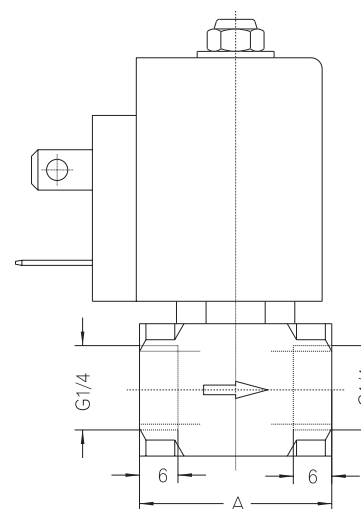

A	type
30	MA 132-011
	-013
	-015
44	MA 132-012
	-014
	-016
	-018

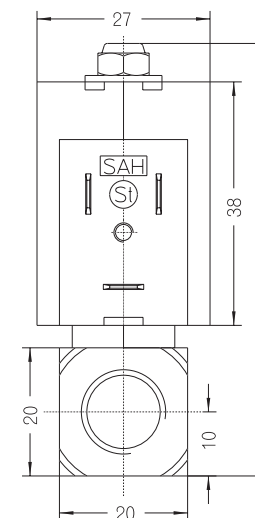

staiger



Dimensions in mm

95